

Getting started with THE ONE

1. Install the pedals:

1.1 Click this link to learn, how to install the pedals:

https://youtu.be/oS_iwq_UPgo

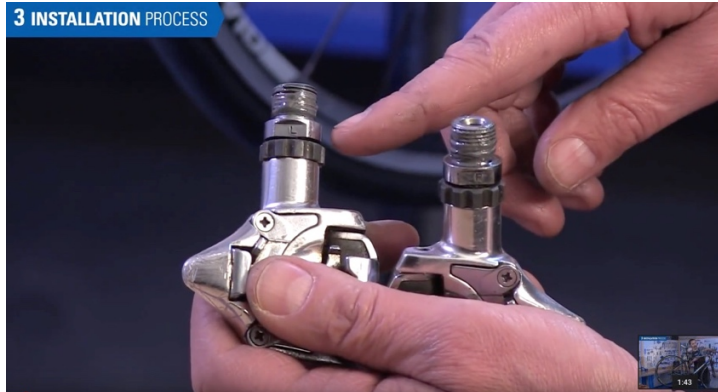

2. Charging the battery:

2.1 Insert the DC plug into the charger jack under the saddle:



2.2 The light of the charger is red when charging and will turn green when the battery is fully charged:



3. **Switch on electronics and display:**

2.3 First switch on the electronics by turning the knob from “O” to “I”

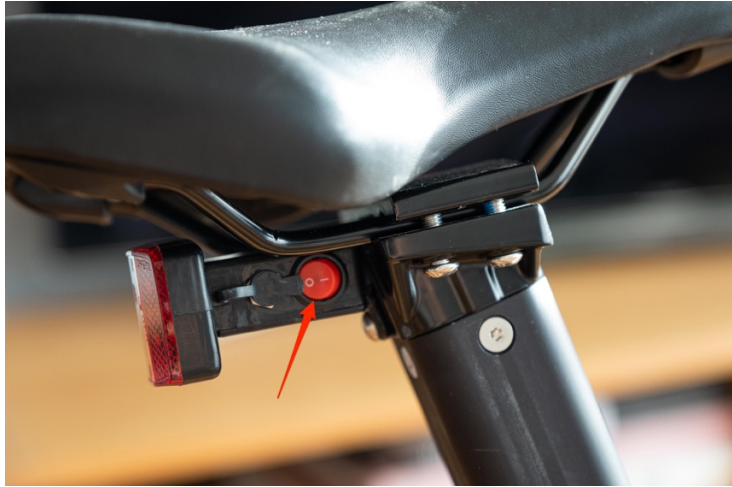

2.1 Turn on the display by pressing the middle button for several seconds:



4. Driving

4.1 Start pedaling to use the pedal assist mode. Press the "+" button to switch to second gear and third gear. Press the "-" button to switch back to second gear and first gear. Press the thumb shifter to use the pure electric mode. You can drive the bike without pedaling in this mode.



5. Change the battery:

5.1 Click this link to learn, how to change the battery:

https://www.youtube.com/watch?v=7RjNEhr_TUE

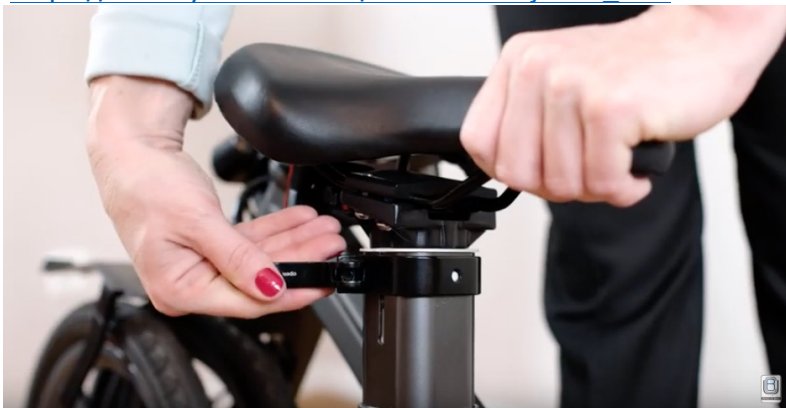

6. Change the display from PH to MPH:

6.1 Switch the controller on, press both up and down arrows until display zeros out and flashes, then use the up arrow to display the number 2, then press the center button, each press changes the little icon KPH MPH. To save press both up and down arrows.